

**Reflex AG Connection set, 1 1/2, incl.
protected shut-off and discharge
Article-No.:9119206**



Reflex AG Connection Set,
complete installation set to be used for
isolation and draining of membrane
expansion vessels in heating, cooling
and water supply systems.

The connection set consists of a vessel
connection, drain valve and lockshield
ball valve for isolation according to
EN 12828.

Especially suitable for expansion
vessels standing on feet with bottom
male threaded connection, e.g.
'reflex G' and 'reflex DE/DE junior'

Merkmale

Type: 1 1/2

Connection: R 1 1/2

max. operating pressure: 10 bar

max. operating temperature: 70°C

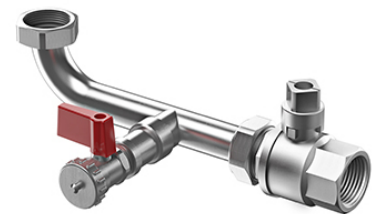

Reflex Winkelmann GmbH

Gersteinstraße 19 • 59227 Ahlen, Germany • Postfach 2261 • 59210 Ahlen, Germany • Tel.: + 49 2382 7069-0 • Fax: + 49 2382 7069-588 • www.reflex.de
Geschäftsführer: Norbert Hülsmann, Volker Mauel

USt.-Ident-Nr.: DE 178 726 058 • Steuer-Nr.: 304/5987/2077 • Handelsregister: Amtsgericht Münster • HRB 13297, Sitz: Ahlen