

**Reflex AG Connection set, 1 1/4, incl.  
protected shut-off and discharge  
Article-No.:9119205**



Reflex AG Connection Set,  
complete installation set to be used for  
isolation and draining of membrane  
expansion vessels in heating, cooling  
and water supply systems.

The connection set consists of a vessel  
connection, drain valve and lockshield  
ball valve for isolation according to  
EN 12828.

Especially suitable for expansion  
vessels standing on feet with bottom  
male threaded connection, e.g.  
'reflex G' and 'reflex DE/DE junior'

---

## **Merkmale**

Type: 1 1/4

Connection: R 1 1/4

max. operating pressure: 10 bar

max. operating temperature: 70°C

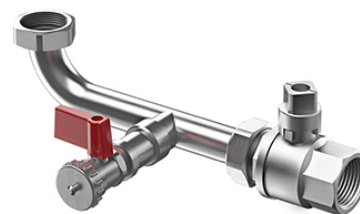

---

### **Reflex Winkelmann GmbH**

Gersteinstraße 19 • 59227 Ahlen, Germany • Postfach 2261 • 59210 Ahlen, Germany • Tel.: + 49 2382 7069-0 • Fax: + 49 2382 7069-588 • [www.reflex.de](http://www.reflex.de)  
Geschäftsführer: Norbert Hülsmann, Volker Mauel

USt.-Ident-Nr.: DE 178 726 058 • Steuer-Nr.: 304/5987/2077 • Handelsregister: Amtsgericht Münster • HRB 13297, Sitz: Ahlen